

Cheng Yu Tung Building

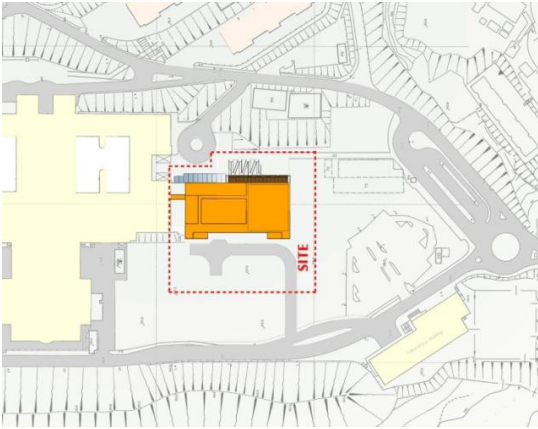

**Planned Completion
- mid 2014**

	sq.m.
- Up to 80 standard offices	1200
-10 research labs each of about 550 sqm. (including write-up and support areas)	5500
- 6 teaching labs each of about 270 sq.m	1620
- 1200 sq.m. classrooms (including 400 seat multi- purpose LT)	1200